



Maximize Your Performance
Minimize Your Price



Specification

Main Output Power RMS	200W+200W (8 ohm), 300W+300W (4 ohm)
Vocal Cancal	for karaoke disc only
Vocal Partner	
Total Harmonic Distortion	<0.1%
Microphone Input	5 (Front x 3, Rear x 2)
Source Input	DVD, VCR, CDG and BGM (Manually)
Microphone Tone	Bass, Treble
Music Tone	Bass, Treble
Key Control Range	9 Steps
Audio Output	2 (pre-out)
AC-Power	110V-120V or 220V-240V (50 Hz-60 Hz) Switchable
Dimension (WxHxD)	17(W) x 7(H) x 16(D) inches 43(W) x 17.8(H) x 40.7(D) cm
Net Weight	28.8 lbs / 13.1 kg
Shipping Weight	34.6 lbs / 15.7 kg

DX-388 G2 is the second generation and improved version of DX-388. It is indeed a hybrid of power amplifier and mixer. The feedback can be controlled easily at the front panel in this unit which has a total of 5 microphone inputs (2 microphone input in the rear specially designed for wireless microphone system). DX-388 G2 is designed to control music and microphone tones easily at the front panel.

COMMERCIAL APPLICATION

For commercial or large space setup, you may need two power amplifiers. The main amplifier is to monitor singing and the auxiliary amplifier is for audience. Please refer to the following diagram for hookup.

If you want to set up the DX-388 G2 inside an auditorium or a commercial business of 2,000 square feet or more, we recommend you using an external power amplifier for output. In this case, you connect the "Audio Out" of DX-388 G2 to a power amplifier and a speaker system (with a 12-inch woofer) with power rating of at least 1,000 watts.

DX-388 G2 REAR VIEW

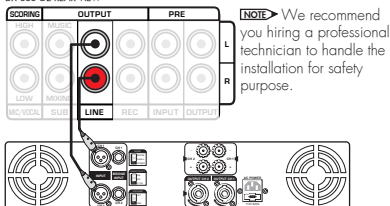

POWER AMPLIFIER REAR VIEW 1,000W.

Figure 1

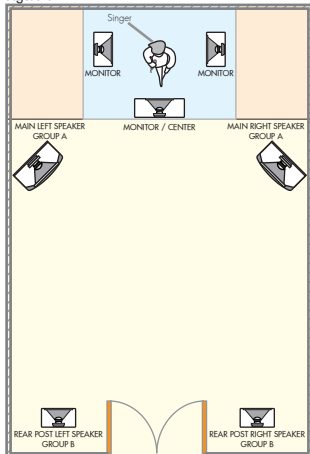
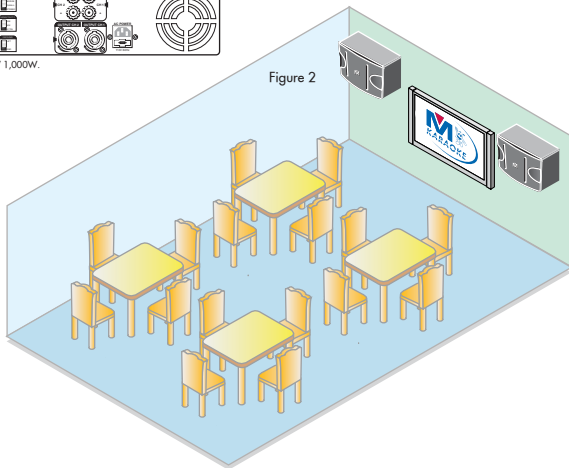

Figure 2



PHYSICAL

Height	7 inches / 17.8 cm
Width	17 inches / 43 cm
Depth	16 inches / 40.7 cm
Net Weight	28.8 lbs / 13.1 kg

Front view

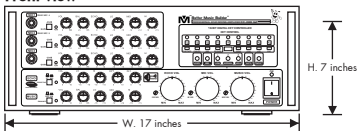

Side view

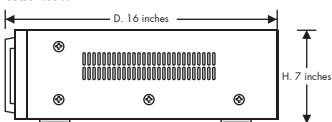

Top view

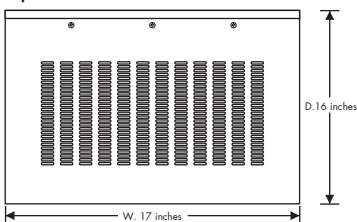

Optional for 19" rack mount kit

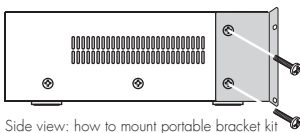
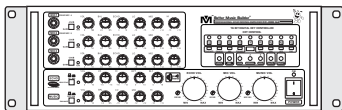

The standard kit is optional. Please make sure that you get the right kit for the size you want. Then, you can put the amplifier into the rack. The rack is used to protect the amplifier. If you have such portable equipment, you can have party at home anytime or use it for Karaoke rental business.

The Mounting Bracket in figure 1 is used to hold your audio/video equipment firmly in place, but not for transportation. If you need to transport the equipment, we recommend you using the heavy duty clamping rack shelf (optional) as illustrated in figure 2. You should place the heavy duty clamping rack shelf into the portable case. This would protect your equipment. There are different sizes of the heavy duty clamping rack shelves to suit your specific needs. Please note that the bracket/handler, rack shelf and case are not included in the package. They are optional items and sold separately.

Amplifier Front Bracket for 19" Rack

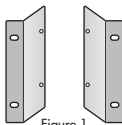

Heavy duty clamping rack shelf

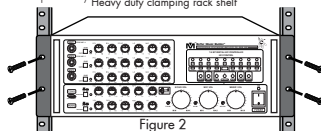

Figure 2

